



ORDERING GUIDE

FOR

10 PAIR HIGH DENSITY

ab & abs TERMINAL BLOCKS

WIRE MANAGEMENT SYSTEM

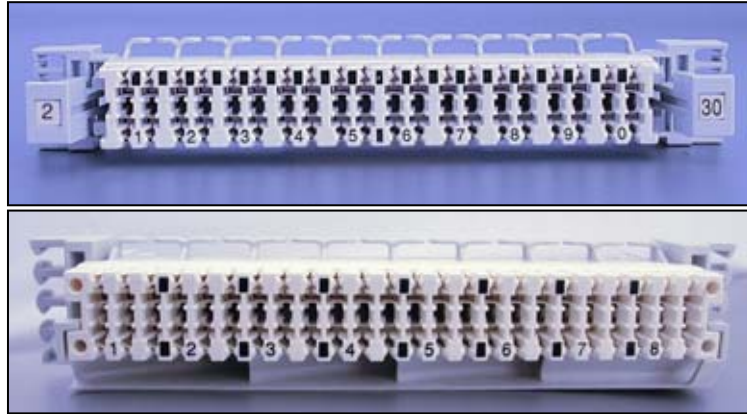

Prepared By:

Approved By:

Technical Support Department
Kunt AŞ
Turgut Özal Cad. NO: 216
34670 İkitelli - İstanbul
Türkiye

Technical Support Manager

CONTENTS

<i>ISSUE AND AMENDMENT RECORD</i>	<i>3</i>
<i>1. INTRODUCTION</i>	<i>4</i>
<i>2. MAGAZINES</i>	<i>5</i>
2.1. 10 Pair High Density Termination Magazines (ab)	5
2.2. 8 Pair High Density Termination Magazines (abs)	5
<i>3. ACCESSORIES</i>	<i>6</i>
3.1. Plugs and Markers	6
3.2. Designation Accessories	7
3.3. MDF Accessories	7
3.4. Protection	8
3.4.1. Overvoltage Protection	8
3.4.2. Overvoltage & Overcurrent Protection	8
3.6. Cords	9
3.6.1 Test Cords	9
3.6.1.1. Test Cords (ab)	9
3.6.1.2. Test Cords (abs)	9
3.6.2 Monitor Cords	10
3.6.2.1. Monitor Cords (ab)	10
3.6.2.2. Monitor Cords (abs)	10
3.6.3 Patch Cords	11
3.6.3.1. Patch Cords (ab)	11
3.6.3.2. Patch Cords (abs)	11
<i>4. INSTALLATION TOOLS</i>	<i>12</i>
<i>5. METALWORK</i>	<i>13</i>
5.1. LSA + Type [®] Mounting Frames	13
5.2. Cabinet Mounting Frames	14
5.2.1. LSA + Type [®] Mounting Frames	14
5.2.2. High Density Mounting Frame (ab)	15
5.2.3. High Density Mounting Frame (abs)	15
<i>6. DUST COVERS</i>	<i>16</i>

Note: Please, give the ORDERING GUIDE VERSION, when ask for a Product contained in this Document

Lead Time: "A" aprox 4 weeks "B" equal or greater than 8 weeks

ISSUE AND AMENDMENT RECORD

DATE	ISSUE NO	AMENDMENT	DESCRIPTION
12/2002	v1.0		Original

This specification supersedes all previous documentation, specifications and data sheets.

Lead Time: "A" aprox 4 weeks "B" equal or greater than 8 weeks

1. INTRODUCTION

Yak-40/41 & Yak-46/46WG are high density termination blocks including connection, disconnection and 8 pair abs product range used for main distribution frames in exchanges and cross connect cabinets in outside plant, and in Building Entrance Terminals, as well as in any commercial building CAT 5 or CAT 5 cabling system.

Connections are made using a unique IDC (insulation displacement contact) to provide a highly reliable connection designed to meet stringent PTT and military electrical and mechanical requirements in a broad range of environmental conditions.

Terminations are made by simply laying the wire over the contact and punching it into the IDC using the manual installation tool. The wire is **cut** by the contact, not by the tool, avoiding the problem of tool blunting which occurs with other systems. During wire removal, each wire pulls out cleanly, leaving no wire residue in the contact.

The design is suitable for analogue, digital and data **applications up to and including CAT 5**.

Terminal Blocks are rated for a minimum of 250 wire **insertion/withdrawal** cycles and eliminates annoying “intermittent” sometimes present with other connection methods.

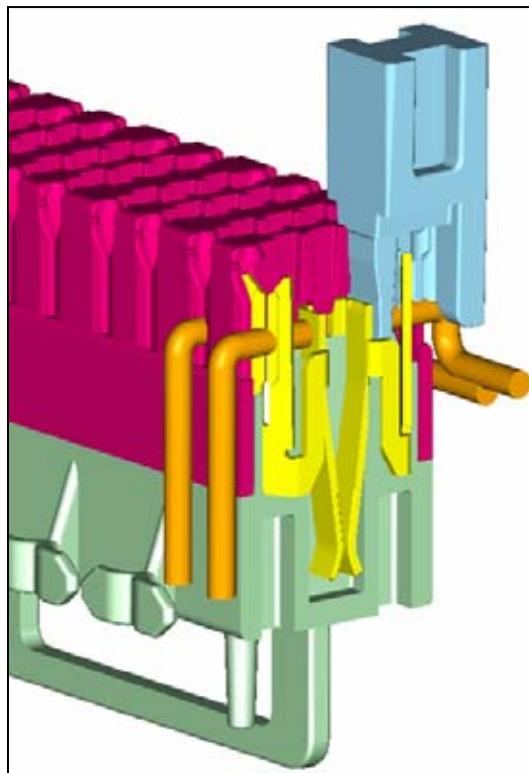

Detail of wire insertion.
The excess of wire is cut by a blade incorporated in the terminal design.

Lead Time: “A” approx 4 weeks “B” equal or greater than 8 weeks

2. MAGAZINES

2.1. 10 PAIR HIGH DENSITY TERMINATION MAGAZINES (ab)

SAP Code	Description	Colour	Lead Time
30966	Yak-40 10 pair Connection Magazine 1-0	Grey	A
31601	Yak-40K 10 pair Connection Magazine, Tin 1-0	Grey	A
31355	Yak-40RU 10 pair Connection Magazine 0-9	Grey	A
30967	Yak-41 10 pair Disconnection Magazine 1-0	White	A
31602	Yak-41K 10 pair Disconnection Magazine, Tin 1-0	White	A
31356	Yak-41RU 10 pair Disconnection Magazine 0-9	White	A

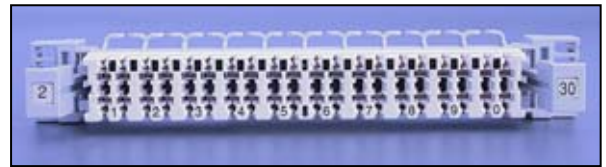

1

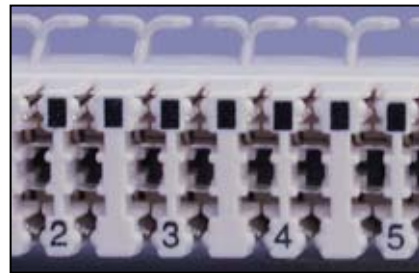

2

10-pair termination ab magazine
 Material: Self extinguishing Thermoplastic material
 Set Content:

- 10 magazines
- 1 disposable tool
- 2 numbering set
- 1 Installation Instruction

2.2. 8 PAIR HIGH DENSITY TERMINATION MAGAZINES (abs)

SAP Code	Description	Colour	Lead Time
30976	Yak-46 8 pair abs Disconnection Magazine	White	A
31603	Yak-46K 8 pair abs Disconnection Magazine, Tin	White	A
31029	Yak-46WG 8 pair abs Disconnection Magazine, w/Wire Guide	White	A
31604	Yak-46K-WG 8 pair abs Disconnection Magazine, Tin, w/Wire Guide	White	A

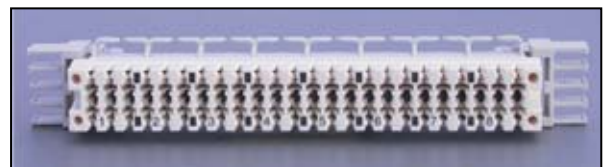

3



4

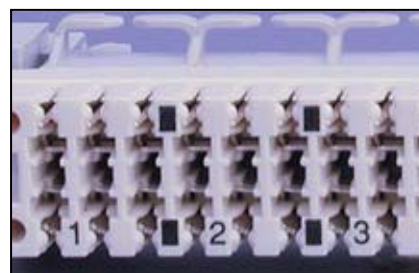

5

10-pair termination abs magazine
 Material: Self extinguishing Thermoplastic material
 Set Content:

- 10 magazines
- 10 label holder
- 1 disposable tool
- 2 numbering set
- 1 Installation Instruction

Shown Pictures:

1. Yak-41
2. Yak-41 detail
3. Yak-46
4. Yak-46WG
5. Yak-46 detail

Lead Time: "A" aprox 4 weeks "B" equal or greater than 8 weeks

3. ACCESSORIES

3.1. PLUGS AND MARKERS

SAP Code	Description	Colour	Lead Time
31342	Yak-41DP-B Disconnection Plug	Black	A
31246	Yak-41DP-R Disconnection Plug	Red	A
31344	Yak-41DP-W Disconnection Plug	White	A

Disconnection plug.

To be use with: Yak-41, Yak-46, Yak-46WG

Set Content:

- 100 pcs disconnection plug

Shown Picture: Yak-41DP-R



SAP Code	Description	Colour	Lead Time
31104	Yak-40MP-B Marking Plug	Black	A
31105	Yak-40MP-R Marking Plug	Red	A
31106	Yak-40MP-W Marking Plug	White	A

Marking plug.

To be use with: Yak-40, 41, 47C, 47D

Set Content:

- 100 pcs marking plug.

Shown Picture: Yak-40MP-R



SAP Code	Description	Colour	Lead Time
31126	YAK-40MC-B Marking Cap	Black	A
31127	YAK-40MC-R Marking Cap	Red	A
31128	YAK-40MC-W Marking Cap	White	A

Marking cap.

To be use with: Yak-40, 41, 47C, Yak-47D

Set Content:

- 100 pcs marking cap.

Shown Picture: Yak-40MC-R

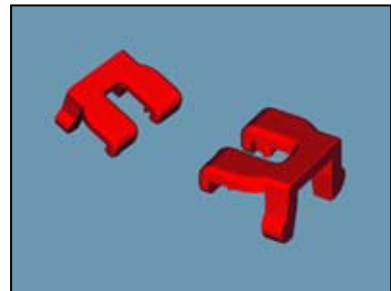

SAP Code	Description	Colour	Lead Time
31373	YAK-46MC-B Marking Cap	Black	A
31247	YAK-46MC-R Marking Cap	Red	A
31374	YAK-46MC-W Marking Cap	White	A

Marking cap.

To be use with: Yak-46, 46WG

Set Content:

- 100 pcs marking cap.

Shown Picture: Yak-46MC-R



SAP Code	Description	Colour	Lead Time
31436	YAK-46MP-B Marking Plug	Black	A
31437	YAK-46MP-R Marking Plug	Red	A
31438	YAK-46MP-W Marking Plug	White	A

Marking Plug

For use with: Yak-46, 46WG

Set Content:

- 100 pcs marking plug.

Shown Picture: Yak-46MP-R



Lead Time: "A" aprox 4 weeks "B" equal or greater than 8 weeks

3.2. DESIGNATION ACCESSORIES

SAP Code	Description	Colour	Lead Time
31338	Yak-40LH-G Hinged Label Holder Set	Grey	A
31339	Yak-46LH-G Hinged Label Holder Set	Grey	A

Hinged label holder.

To be used with:

Yak-40LH-G; Yak-40 & 41

Yak-46LH-G; Yak-46 & 46WG

Set Content:

- 1 plate
- 1 left holder
- 1 right holder
- 1 label

Shown Pictures:

1. Yak-40LH-G

2. Yak-46LH-G



1



2

3.3. MDF ACCESSORIES

SAP Code	Description	Lead Time
31353	Yak-41MDF-MK MDF Mounting Frame Kit	A

MDF mounting frame kit. This is used for mounting frames on bars.

Set Content:

- 4 mounting screws and washers
- 4 plastic hooks



Lead Time: "A" aprox 4 weeks "B" equal or greater than 8 weeks

3.4. PROTECTION

3.4.1. OVERVOLTAGE PROTECTION

SAP Code	Description	Colour	Lead Time
31144	Yak-44/2-3 Protector 3P, Dry	Grey	B

3-point overvoltage protection, 230 V Gas Discharge Tube.

To be used with: Yak-41,

Set Content:

- 10 protectors
- 1 ground terminal
- 1 Installation Instruction

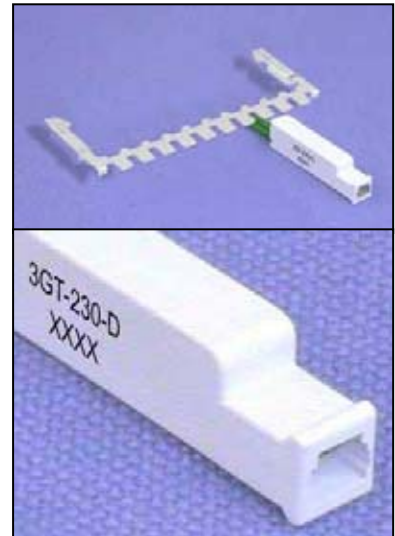

3.4.2 OVERVOLTAGE & OVERCURRENT PROTECTION

SAP Code	Description	Colour	Lead Time
31146	Yak-44/2-5 Protector 5P, Dry	Grey	B

5-point overvoltage + overcurrent protection, 230 V Gas

To be used with: Yak-41,
Discharge Tube.

Set Content:

- 10 protectors
- 1 ground terminal
- 1 Installation Instruction

! Yak-44/2-5 can not be used with Yak-40DC/100-S and Yak-40DC/100-L

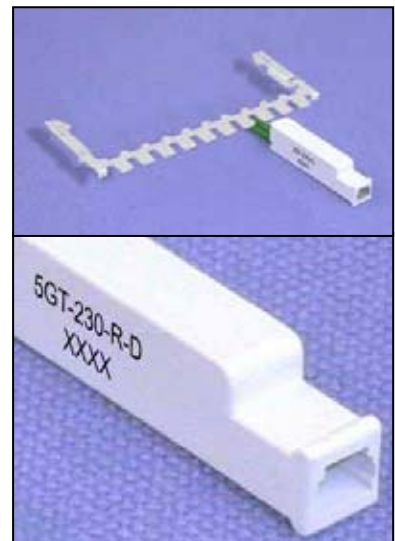

SAP Code	Description	Lead Time
31364	YAK-40EC Earthing Contact	A

Earthing contact

To be use with: Yak-41

Set Content:

- 10 Contact

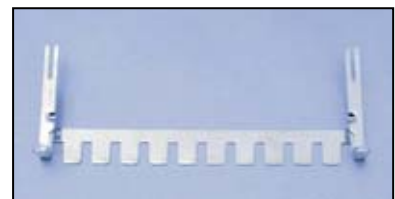

Lead Time: "A" aprox 4 weeks "B" equal or greater than 8 weeks

3.6. CORDS

3.6.1. TEST CORDS

3.6.1.1 TEST CORDS (ab)

SAP Code	Description	Length	Lead Time
31448	YAK-43/2 Head Only	-	A
31315	YAK-43/2-2-PB ab 4x4 Test Cord, banana ended	2 metres	A
31316	YAK-43/2-4-PB ab 4x4 Test Cord, banana ended	4 metres	A
31317	YAK-43/2-2-PW ab 4x4 Test Cord, wire ended	2 metres	A
31318	YAK-43/2-4-PW ab 4x4 Test Cord, wire ended	4 metres	A

4x4 ab test cords.

To be used with: Yak-41

Set Content:

- 1 Test Cord
- 1 Leaflet

Shown Picture: YAK-43/2-X-PB ab Xm 4x4 Test Cord, banana ended



3.6.1.2 TEST CORDS (abs)

SAP Code	Description	Length	Lead Time
31449	YAK-43S/2 Head Only	-	A
31303	YAK-43S/2-2-PB abs 4+1 Test Cord, banana ended	2 metres	A
31304	YAK-43S/2-4-PB abs 4+1 Test Cord, banana ended	4 metres	A
31305	YAK-43S/2-2-PW abs 4+1 Test Cord, wire ended	2 metres	A
31306	YAK-43S/2-4-PW abs 4+1 Test Cord, wire ended	4 metres	A

4+1 abs test cords.

To be used with: Yak-46 & 46WG

Set Content:

- 1 Test Cord
- 1 Leaflet

Shown Picture: YAK-43S/2-X-PB abs Xm 4+1 Test Cord, banana ended

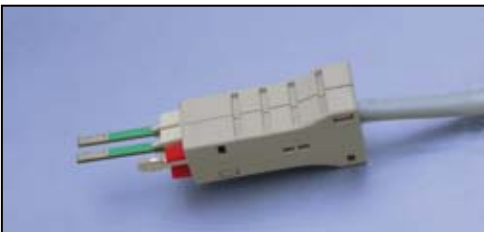

Lead Time: "A" aprox 4 weeks "B" equal or greater than 8 weeks

3.6.2 MONITOR CORDS

3.6.2.1 MONITOR CORDS (ab)

SAP Code	Description	Length	Lead Time
31450	YAK-43/1 Head Only	-	A
31309	YAK-43/1-2-PB ab 2x2 Monitor Cord, banana ended	2 metres	A
31310	YAK-43/1-4-PB ab 2x2 Monitor Cord, banana ended	4 metres	A
31311	YAK-43/1-2-PW ab 2x2 Monitor Cord, wire ended	2 metres	A
31312	YAK-43/1-4-PW ab 2x2 Monitor Cord, wire ended	4 metres	A

2x2 ab monitor cords.

To be used with: Yak-40

Set Content:

- 1 Test Cord
- 1 Leaflet

Shown Picture: YAK-43/1-X-PB ab Xm 2x2 Monitor Cord, banana ended



3.6.2.2 MONITOR CORDS (abs)

SAP Code	Description	Length	Lead Time
31451	YAK-43S/1 Head Only	-	A
31297	YAK-43S/1-2-PB abs 2+1 Monitor Cord, banana ended	2 metres	A
31298	YAK-43S/1-4-PB abs 2+1 Monitor Cord, banana ended	4 metres	A
31299	YAK-43S/1-2-PW abs 2+1 Monitor Cord, wire ended	2 metres	A
31300	YAK-43S/1-4-PW abs 2+1 Monitor Cord, wire ended	4 metres	A

2+1 abs monitor cords.

To be used with: Yak-46 & 46WG

Set Content:

- 1 Test Cord
- 1 Leaflet

Shown Picture: YAK-43S/1-X-PB abs Xm 2+1 Monitor Cord, banana ended

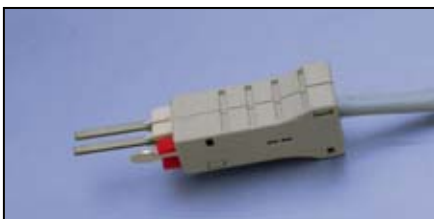

Lead Time: "A" aprox 4 weeks "B" equal or greater than 8 weeks

3.6.3. PATCH CORDS

3.6.3.1. PATCH CORDS (ab)

SAP Code	Description	Length	Lead Time
31319	YAK-43/2-2-PP ab 4x4 Patch Cord, plug ended	2 metres	A
31320	YAK-43/2-4-PP ab 4x4 Patch Cord, plug ended	4 metres	A
31313	YAK-43/1-2-PP ab 2x2 Patch Cord, plug ended	2 metres	A
31314	YAK-43/1-4-PP ab 2x2 Patch Cord, plug ended	4 metres	A

ab patch cords,

To be used with: Yak-40 & 41

Set Content:

- 1 Test Cord
- 1 Leaflet

Shown Picture: YAK-43/1-X-PP ab Xm 2x2 Patch Cord, plug ended



3.6.3.2. PATCH CORDS (abs)

SAP Code	Description	Length	Lead Time
31307	YAK-43S/2-2-PP abs 4+1 Patch Cord, plug ended	2 metres	A
31308	YAK-43S/2-4-PP abs 4+1 Patch Cord, plug ended	4 metres	A
31301	YAK-43S/1-2-PP abs 2+1 Patch Cord, plug ended	2 metres	A
31302	YAK-43S/1-4-PP abs 2+1 Patch Cord, plug ended	4 metres	A

abs patch cords

To be used with: Yak-46 & 46WG

Set Content:

- 1 Test Cord
- 1 Leaflet

Shown Picture: YAK-43S/1-X-PP abs Xm 2+1 Patch Cord, plug ended

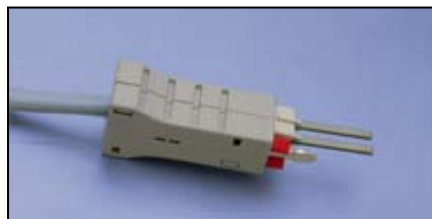
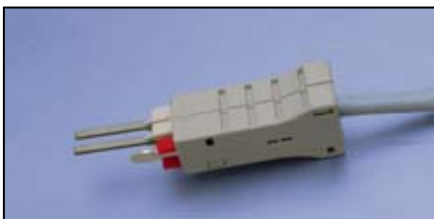

Lead Time: "A" aprox 4 weeks "B" equal or greater than 8 weeks

4. INSTALLATION TOOLS

SAP Code	Description	Lead Time
31348	Yak-42S Insertion Tool, Short	A

Insertion tool **short** version.

To be used with: Yak-40/41, Yak-46/46WG

Set Content:

- 1 Tool
- 1 Leaflet



SAP Code	Description	Lead Time
31349	Yak-42L Insertion Tool, Long	A

Insertion tool **long** version.

To be used with: Yak-40/41, Yak-46/46WG Set Content:

- 1 Tool
- 1 Leaflet



SAP Code	Description	Colour	Lead Time
31350	Yak-42D Insertion Tool, Disposable	Black	A

Disposable tool.

Material: polyamide

To be used with: Yak-40/41, Yak-46/46WG

Set Content:

- 50 Disposable Tool
- 1 Leaflet



! Yak-42D can be re-used up to around 400 reinsertions with cable dia. < 0,8

Lead Time: "A" aprox 4 weeks "B" equal or greater than 8 weeks

5. METALWORK

5.1 LSA + TYPE[®] MOUNTING FRAMES

SAP Code	Description	Lead Time
30642	Yak-70/10-12 BMF ; 10 pair ; 12 mm depth	A
30643	Yak-70/10-22 BMF ; 10 pair ; 22 mm depth	A
31382	Yak-70/10-30 BMF ; 10 pair ; 30 mm depth	A
31383	Yak-70/10-50 BMF ; 10 pair ; 50 mm depth	A
30644	Yak-70/20-12 BMF ; 20 pair ; 12 mm depth	A
30645	Yak-70/20-22 BMF ; 20 pair ; 22 mm depth	A
31384	Yak-70/20-30 BMF ; 20 pair ; 30 mm depth	A
31385	Yak-70/20-50 BMF ; 20 pair ; 50 mm depth	A
30646	Yak-70/30-12 BMF ; 30 pair ; 12 mm depth	A
30647	Yak-70/30-22 BMF ; 30 pair ; 22 mm depth	A
30648	Yak-70/40-22 BMF ; 40 pair ; 22 mm depth	A
30649	Yak-70/50-22 BMF ; 50 pair ; 22 mm depth	A
30650	Yak-70/50-30 BMF ; 50 pair ; 30 mm depth	A
31386	Yak-70/50-50 BMF ; 50 pair ; 50 mm depth	A
30651	Yak-70/60-22 BMF ; 60 pair ; 22 mm depth	A
30652	Yak-70/60-30 BMF ; 60 pair ; 30 mm depth	A
30653	Yak-70/60-50 BMF ; 60 pair ; 50 mm depth	A
30654	Yak-70/70-22 BMF ; 70 pair ; 22 mm depth	A
30655	Yak-70/80-22 BMF ; 80 pair ; 22 mm depth	A
30656	Yak-70/100-22 BMF ; 100 pair ; 22 mm depth	A
30657	Yak-70/100-30 BMF ; 100 pair ; 30 mm depth	A
30658	Yak-70/100-50 BMF ; 100 pair ; 50 mm depth	A
30659	Yak-70/110-30 BMF ; 110 pair ; 30 mm depth	A
30660	Yak-70/110-50 BMF ; 110 pair ; 50 mm depth	A
30806	Yak-70/200-50 BMF ; 200 pair ; 50 mm depth	A
30846	Yak-70/210-50 BMF ; 210 pair ; 50 mm depth	A
31046	Yak-70/300-50 BMF ; 300 pair ; 50 mm depth	A
30661	Yak-70/310-50 BMF ; 310 pair ; 50 mm depth	A
30662	Yak-70/330-50 BMF ; 330 pair ; 50 mm depth	A



1



2

LSA+ mounting frame:

Material: stainless steel.

To be used with: Yak-40/41, Yak-46/46WG

Set Content:

- 1 pcs Back Mount Frame

Shown Pictures;

1- Yak-70/100-30

2- Yak-70/330-50

Lead Time: "A" aprox 4 weeks "B" equal or greater than 8 weeks

5.2. CABINET MOUNTING FRAMES

5.2.1 LSA + TYPE[®] MOUNTING FRAMES

SAP Code	Description	Lead Time
31036	Yak-70EVs/100-44 BMF ; 100pair	A

Cabinet mounting frame: 44 mm depth, 11 positions.

Material: stainless steel.

To be used with Yak-20/21 Yak-40/41, Yak-46/46WG and Yak-47D/47C

Set Content:

- 1 pcs Back Mount Frame
- Assembly Kit

! for cross-connection cabinets only

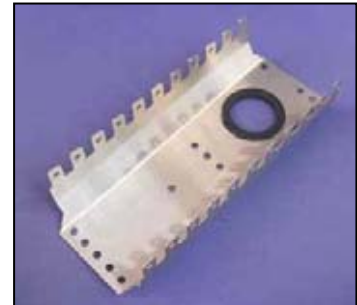

SAP Code	Description	Lead Time
31037	Yak-70EVs/50-44 BMF ; 50pair	A

Cabinet Mounting frame: 44 mm depth, 6 positions

Material: stainless steel.

To be used with Yak-20/21 Yak-40/41, Yak-46/46WG and Yak-47D/47C

Set Content:

- 1 pcs Back Mount Frame
- Assembly Kit

! for cross-connection cabinets only



Lead Time: "A" approx 4 weeks "B" equal or greater than 8 weeks

5.2.2 HIGH DENSITY MOUNTING FRAME (ab)

SAP Code	Description	Lead Time
31129	Yak-71/100-65 ab Back Mount Frame, 100pair 65mm	A

Mounting frame: 65 mm depth, 10 positions.

Material: stainless steel.

To be used with: Yak-40/41

Set Content:

- 1 pcs Back Mount Frame

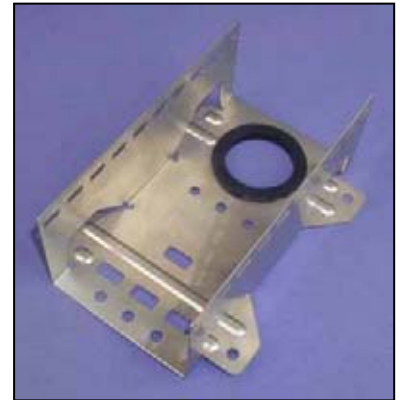

5.2.3 HIGH DENSITY MOUNTING FRAME (abs)

SAP Code	Description	Lead Time
31375	Yak-71S/100-65 abs Back Mount Frame, 80pair 65 mm	A

Mounting frame: 65 mm depth, 10 positions.

Material: stainless steel.

To be used with: Yak-46,

Set Content:

- 1 pcs Back Mount Frame



Lead Time: "A" aprox 4 weeks "B" equal or greater than 8 weeks

6. DUST COVERS

SAP Code	Description	Lead Time
31351	Yak-40DC/100-S Dust Cover, Short	A

High density dust covers

To be used with: Yak-71/100-65 & Yak-71S/100-65,

Set Content:

- 1 pcs. Dust cover



SAP Code	Description	Lead Time
31352	Yak-40DC/100-L Dust Cover, Long	A

LSA + type dust cover

To be used with: Yak-70/100 & Yak-70/110 series

Set Content:

- 1 pcs. Dust cover



LSA +[®] is a Trade Mark of Krone

Lead Time: "A" aprox 4 weeks "B" equal or greater than 8 weeks